

- Proprietary frameless louvre system and door
Spec. Ref. L10/650A and L20/445
- Render on insulation wall finish
Spec. Ref. M21
- Ductwork enters room directly to ceiling void
- AHU and ductwork concealed in external plant area as per M&E specifications
- Rooflight to art gallery office with grating as protection
Spec. Ref. L10/460A
- Frameless glass screen with one fixed and one sliding section fixed in door style heavy duty slide rail
- Empty conduit used for power/ data/ telecoms to desk
- Resin floor finish throughout
Spec. Ref. M12/110A

1 Section
see 2121 Scale 1:50

- general notes:**
Do not scale from this drawing for construction purposes
All dimensions are to be verified on site by the contractor and any discrepancies or omissions reported to the Architect prior to any works being carried out
Property of **keith williams architects**
Copyright Reserved
- SYMBOLS REFERENCE**
- Wall mounted twin 13A switched socket outlet c/w USB charging.
 - Twin 13A switched socket outlet mounted at counter level.
 - Cleaning socket outlet.
 - Fused spur outlet.
 - Telephone outlet.
 - Computer outlet.
 - External socket outlet IP rate wall mounted.
 - Rounded floor box flush type / Hinged lid
 - Rounded floor box flush type / Screwed lid
 - Intruder alarm panel c/w power supply
 - Main distribution board
 - Motor control centre
 - Intermediate distribution frame

PLEASE NOTE:
1-This drawing should be read with AXISENG Electrical documents and drawing package.

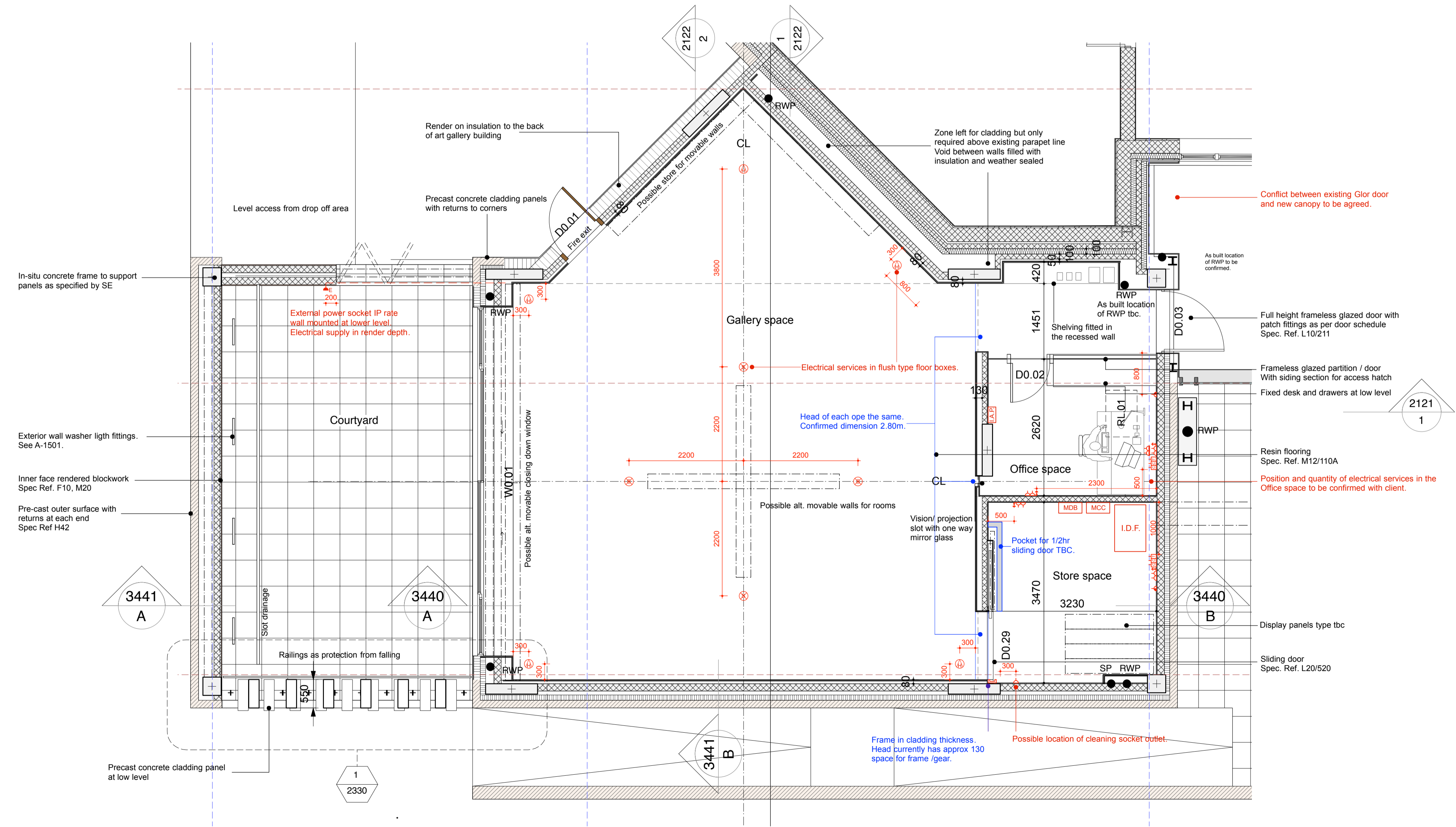

Revisions

Rev.	Date	Check	Description
RC1	25/04/2022	-	Issued for construction
RC2	27/06/2022	-	Floor boxes setting out revised; Electrical services added; Blockwork wall thick, updated and wall lining system added as per GA drawings; Recess on wall created at the entrance corridor.
RC3	19/07/2022	-	Floor boxes model and setting out revised; External socket added; Wall mounted luminaire (X8 type) in the Courtyard relocated; Ceiling H updated; Pocket for fire rated door D0.29 added;
RC4	19/02/2024	-	Ceiling dropped as per Coosivina request, and through detail reintroduced at the perimeter.

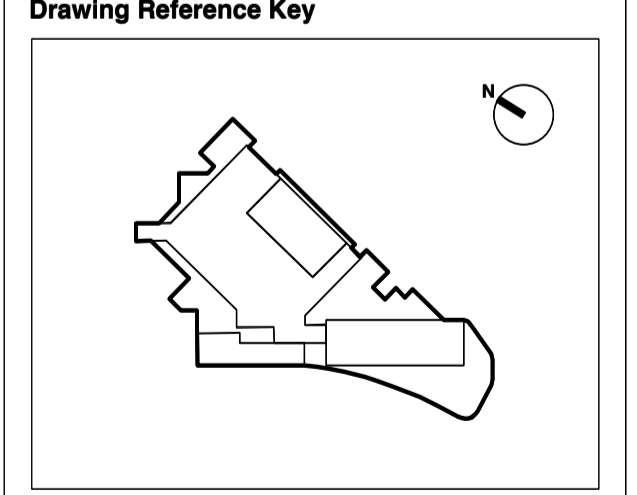

keith williams architects
74 Long Lane
London SE1 4AU
Tel: + 44(0)20 7843 0070

client: **Clare County Council**
County Clare Library

job: **Art Gallery Sheet 01**

drawing title: **Art Gallery Sheet 01**

job:	275	stage:	Construction	rev:	RC4
asset reference:	project:	originator:	volume:	level:	type:
CCC-KWA-X-00-DR-A-2121					
date: 24/04/2017 scale: 1:10 / 1:50 @ A1					

2 Plan
see 1101 Scale 1:50